



Michael Saunders & Company®

Commercial  
LICENSED REAL ESTATE BROKER

9,075 SQ. FT. INDUSTRIAL OFFICE / WAREHOUSE SPACE



7685 MATOAKA ROAD

SARASOTA, FLORIDA

LEASE \$4,350 PER MONTH, GROSS

ALL PROPERTIES ARE FEATURED AT

[www.SARASOTA-INDUSTRIAL.COM](http://www.SARASOTA-INDUSTRIAL.COM)

941.957.3730  
OFFICE

ROBERTA "BJ" KOLTON

[RobertaKolton@MichaelSaunders.com](mailto:RobertaKolton@MichaelSaunders.com)

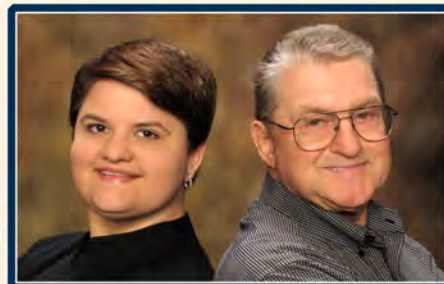

941.552.5216  
FAX

ROBERT "BOB" KOLTON

[RobertKolton@MichaelSaunders.com](mailto:RobertKolton@MichaelSaunders.com)

SPECIALIZING IN INDUSTRIAL & COMMERCIAL PROPERTIES

Price and availability is subject to change without notice. The information being provided to you is not guaranteed to be free of errors. No independent verification of the accuracy of any information or documentation is represented by the real estate licensee. If you intend to rely on the information provided, you are notified that you should confirm any such information directly with the appropriate governmental authority, the seller and its counsel, or your own independent advisors and counsel. Any copyrighted material shall remain such. Unless provided in writing, no information or documentation provided shall be distributed, disseminated, or reproduced to any third party.

## Property Information Sheet

7685 Matoaka Road  
Bradenton

**Square Feet: 9,075**

Sq. Ft. Office: 1,900

Sq. Ft. Shop: 7,175

**Land Size: 1.83 Acres** (79,695 sq. ft.)

**Zoning: L-M**

**Year Built: 1985**

**Electrical (Phase): Three**

Amps - Volts: 200 - 110/220

**Ceiling Height: 18'**

**Overhead Doors: 1 - 25' X 16'**

**Loading Dock: No**

**Fire Sprinklers: No**

**Parking: 12**

**Taxes:**

**Occupancy: At lease execution.**

**Industrial Park: Tallevast Industrial Park**

**\$0.00**

Sales Price

**\$0.00**

Per Sq. Ft.

**\$4,350.00**

Lease Rate

**\$5.75**

Per Sq. Ft.

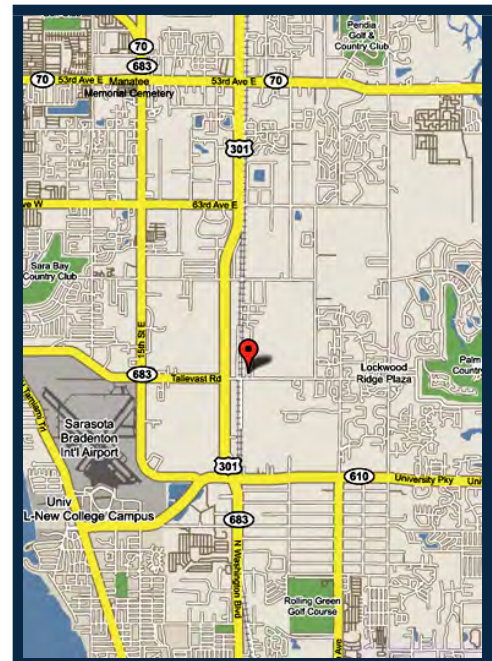

9,075 sq. ft. unit with spacious office area, recently remodeled in modern industrial design. Warehouse has 18' ceilings, 3-phase power, and large 25' x 16' overhead door. Located in the Tallevast Industrial Park, a great central location for easy access to Sarasota and Manatee via Highway 301. Rent quoted includes common area charge of \$946.00 per month which covers real estate taxes, insurance, water, sewer, and landscaping service.

Call Bob or Roberta Kolton at 941.957.3730 for more information.

THE INFORMATION CONTAINED HEREIN PRESENTED IS BELIEVED TO BE FACTUAL TO THE BEST OF OUR KNOWLEDGE BUT SHOULD NOT BE CONSTRUED TO BE WARRANTED BY MICHAEL SAUNDERS AND COMPANY.

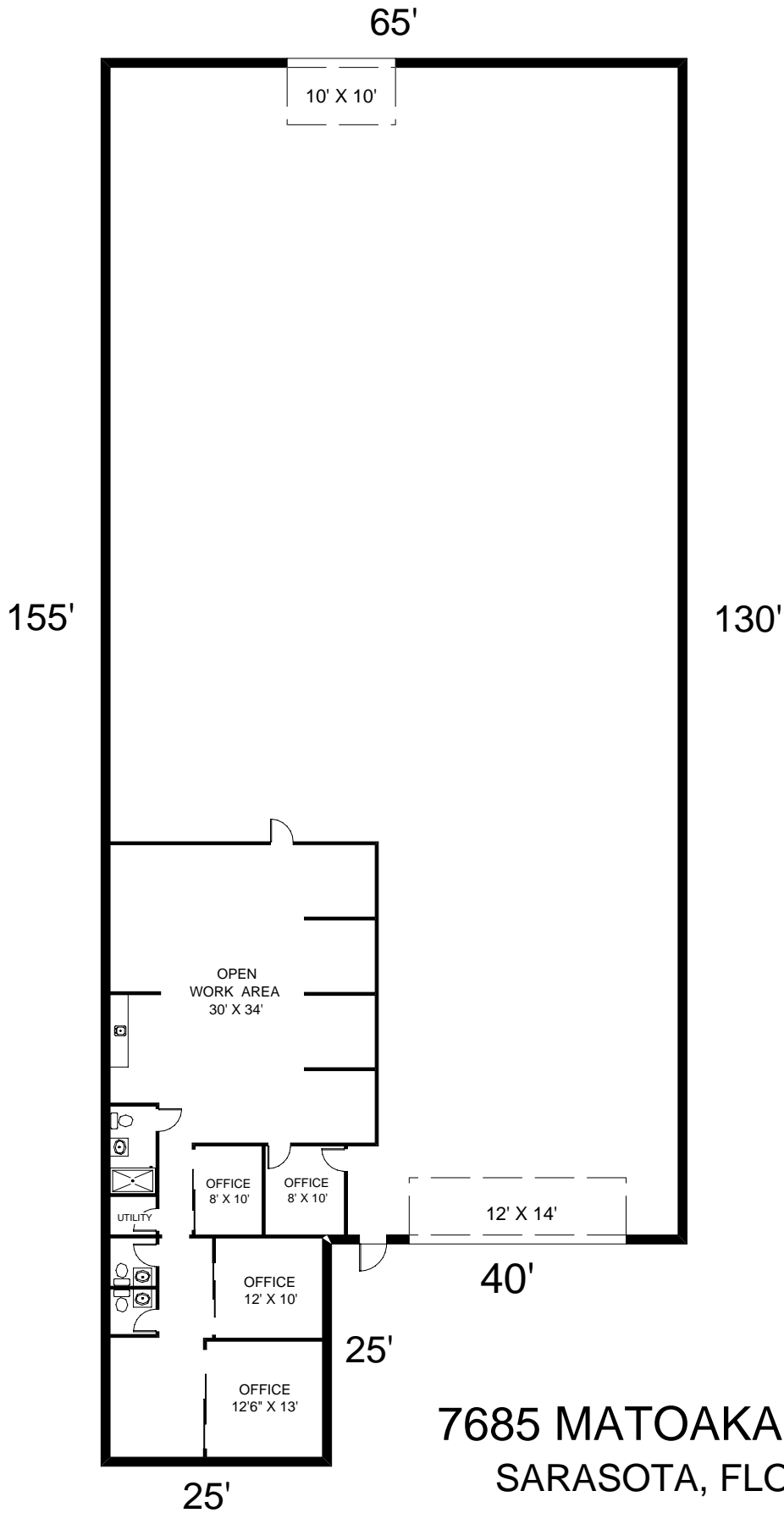

**7685 MATOAKA ROAD  
SARASOTA, FLORIDA**

NOTE: Not drawn to exact scale. Some measurements are approximate. Do not duplicate, publish, modify or otherwise distribute these materials unless specifically authorized by Bob Kolton, Roberta Kolton or Michael Saunders & Company. The information being provided to you is not guaranteed to be free of errors. No independent verification of the accuracy of any information or documentation is represented by the real estate licensee.